

In-wall dimmer

Adjusting Low-End Trim -
To optimize performance of dimmable LED lamps

1 Enter

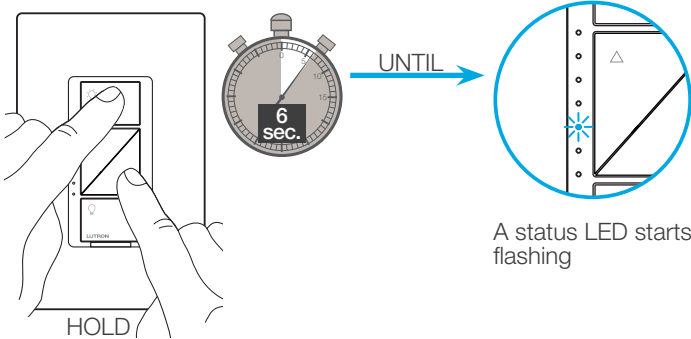

2 Adjust

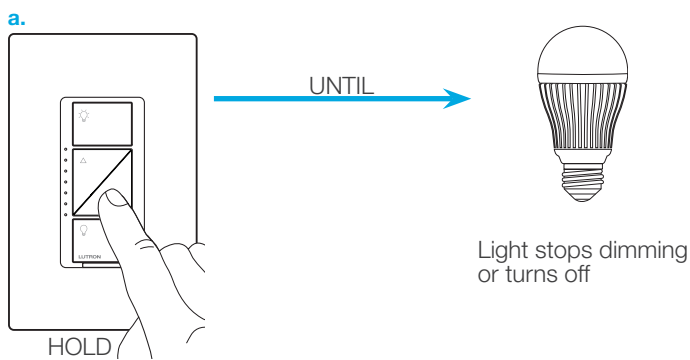

2 Adjust (continued)

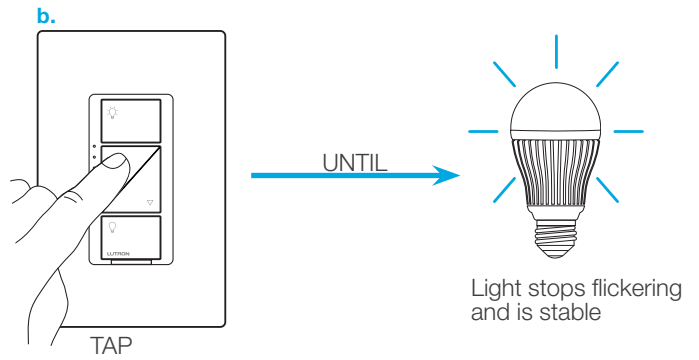

3 Save

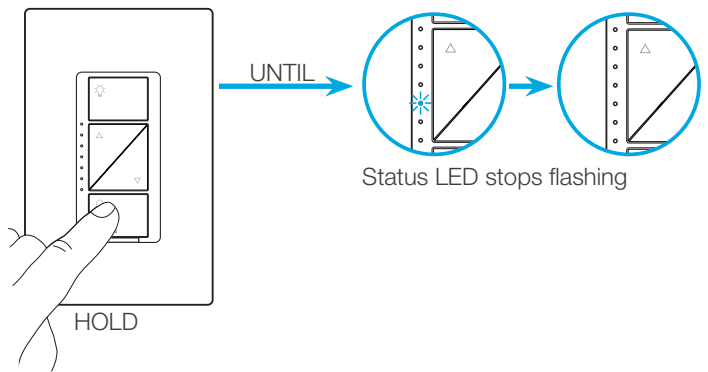

4 Verify

- a.
- b.
- a. Tap "Off" one time. Light will turn off.
 - b. Tap "Brighter" one time. Light will turn on.
 - c. If light is still off or is flickering, repeat steps 1-4.

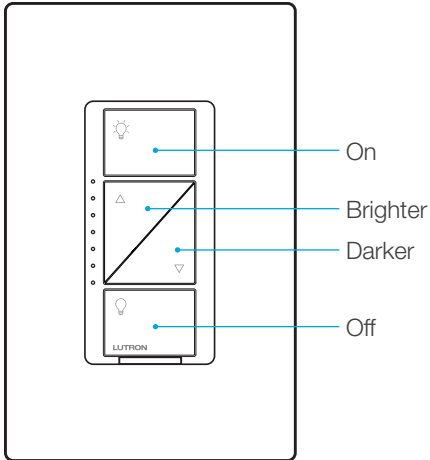

In-wall PRO dimmer

Adjusting Low-End Trim -
To optimize performance of dimmable LED lamps

1 Enter

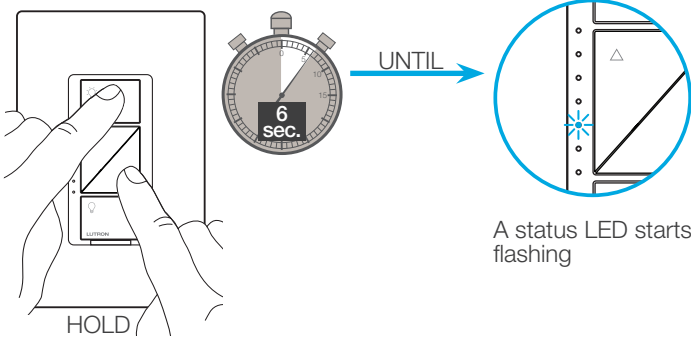

2 Adjust

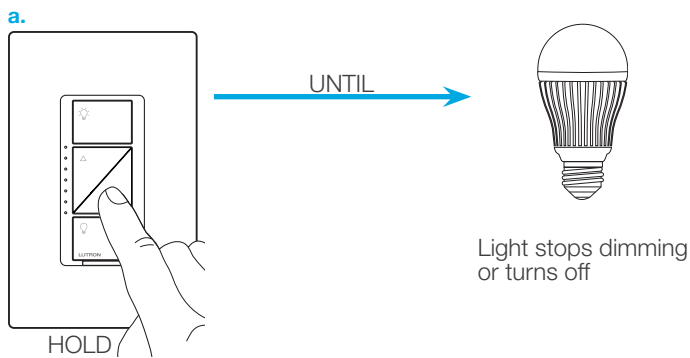

2 Adjust (continued)

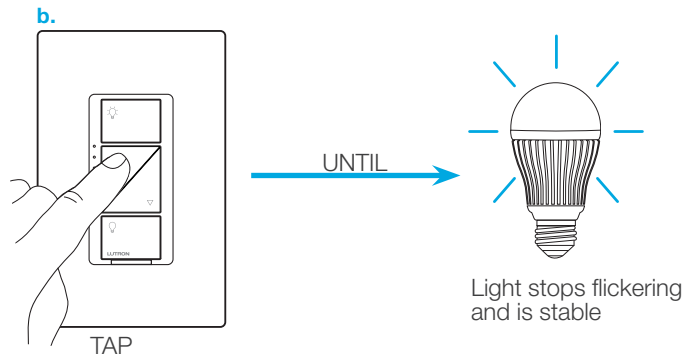

3 Save

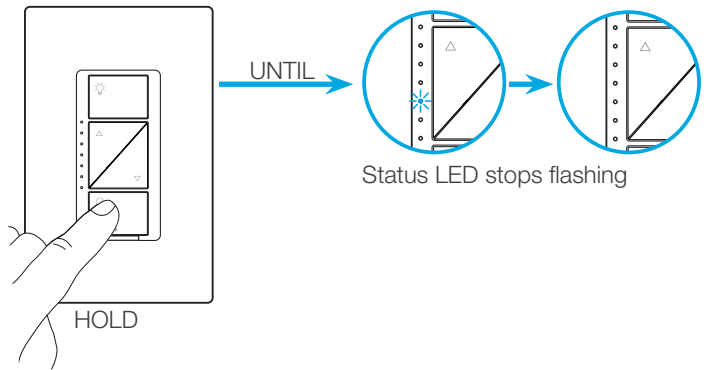

4 Verify

- a.
- b.
- a. Tap "Off" one time. Light will turn off.
 - b. Tap "Brighter" one time. Light will turn on.
 - c. If light is still off or is flickering, repeat steps 1-4.

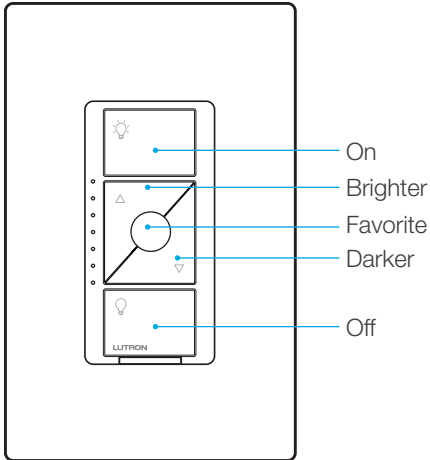

In-wall dimmer

Adjusting Low-End Trim -
To optimize performance of dimmable LED lamps

1 Enter

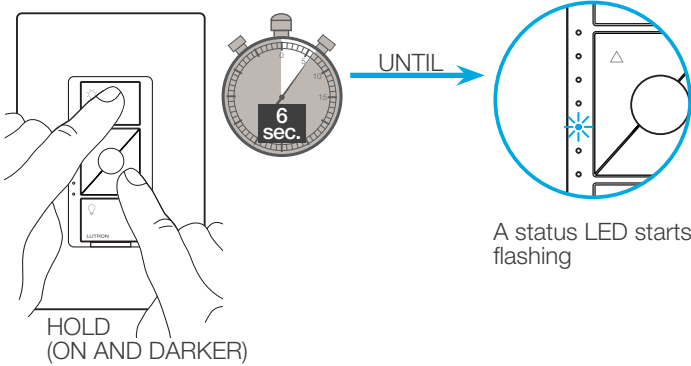

2 Adjust

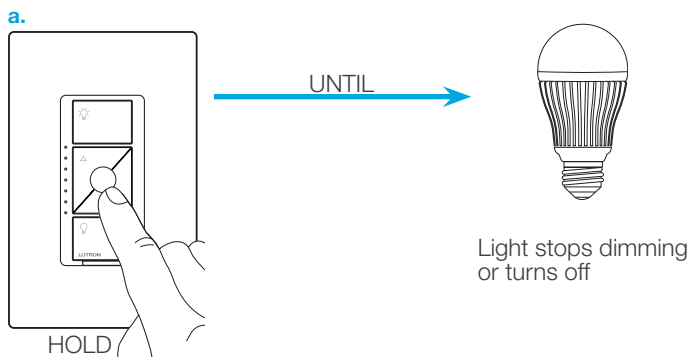

2 Adjust (continued)

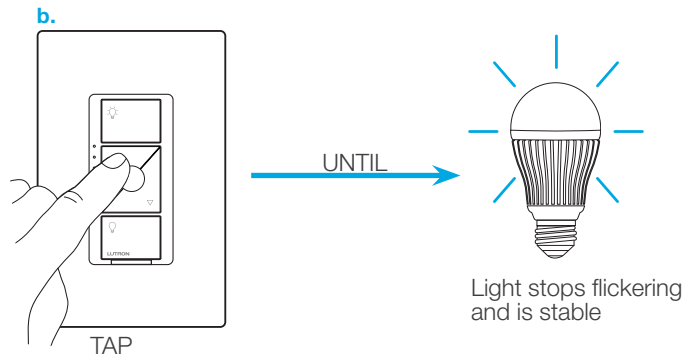

3 Save

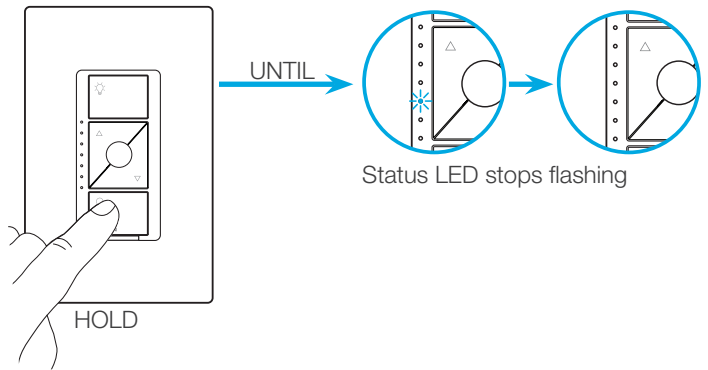

4 Verify

- a.
-
- a. Tap "Off" one time. Light will turn off.
- b.
-
- b. Tap "Brighter" one time. Light will turn on.
- c. If light is still off or is flickering, repeat steps 1-4.

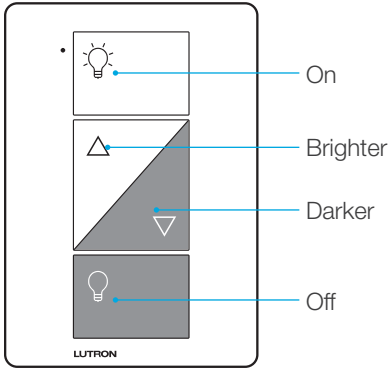

Plug-in lamp dimmer

Adjusting Low-End Trim - To optimize performance of dimmable LED lamps

1 Enter

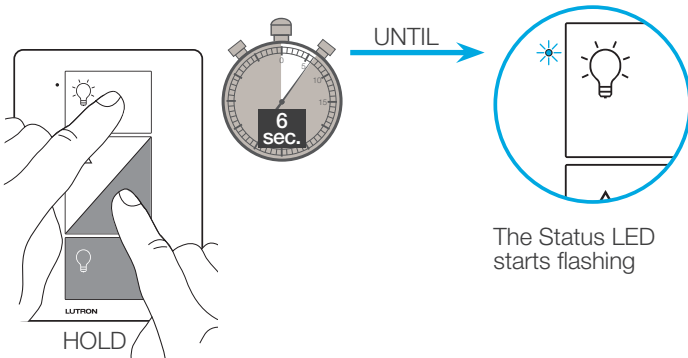

The Status LED starts flashing

2 Adjust

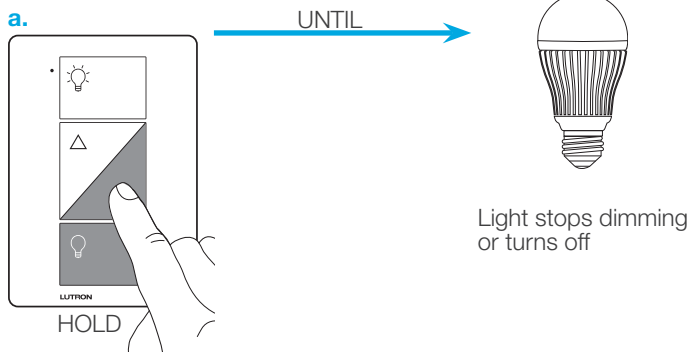

Light stops dimming or turns off

2 Adjust (continued)

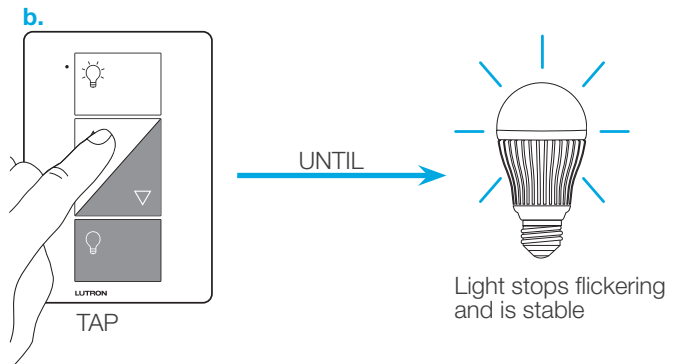

Light stops flickering and is stable

3 Save

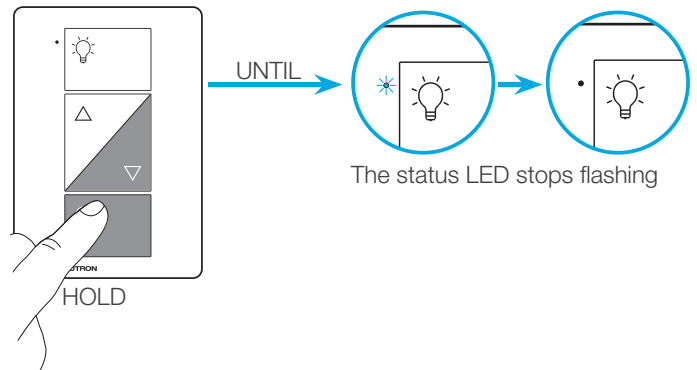

The status LED stops flashing

4 Verify

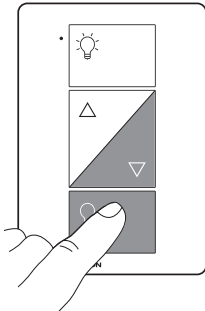
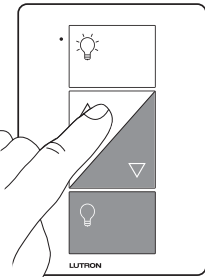
- a.  Tap "Off" one time. Light will turn off.
- b.  Tap "Brighter" one time. Light will turn on.
- c. If light is still off or is flickering, repeat steps 1-4.